

REV	ECO	BY	DESCRIPTION	APV	DATE
A	31259	AS	Initial Design	MP	02/21/13

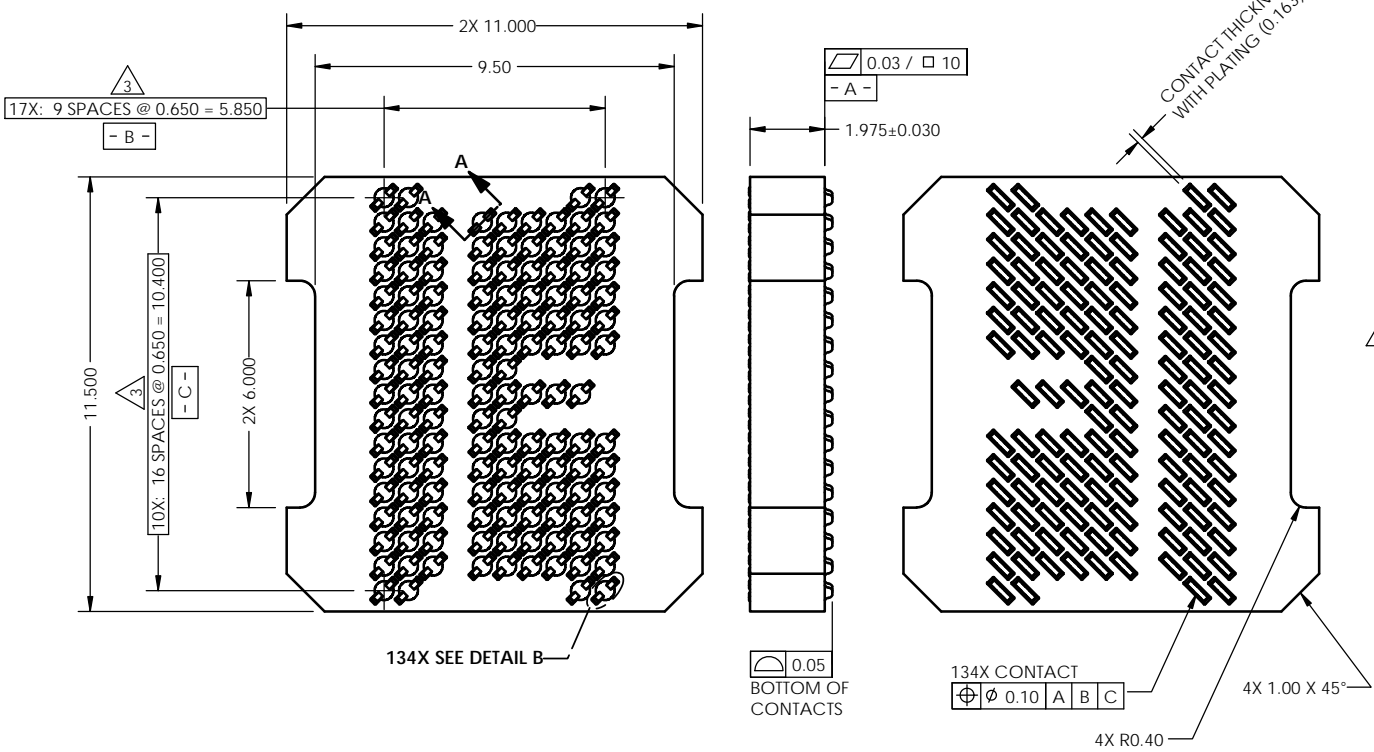

- Notes:
- Footprint part number is 104311-0258.
 - Unless otherwise noted, all features located $\text{Ø} 0.10$ A B C
 - Locates center of contact slots.
 - Datums - B - and - C - determined by $\text{Ø} 0.500$ opening in corner slots.

PARTS LIST	
Part Number	Description
106918-0012	SCKT, 134GRY11X11.5-0.65
106919-0012	CS, 134GRY11X11.5-0.65
103864-0061	PRESS, DEV INS, 11X11.5 (SOLD SEP.)
104553-0196	STEN,FLEX, 134GRY11X11.5-0.65 (SOLD SEP.)
105900-0004	EXTRACTION TOOL, 4X53 (SOLD SEP.)

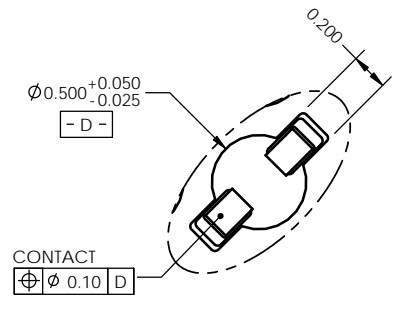
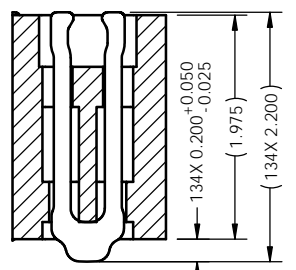

HSIOtechnologies
 PROPRIETARY AND CONFIDENTIAL
 THE INFORMATION CONTAINED IN THIS DRAWING IS THE SOLE PROPERTY OF HSIO TECHNOLOGIES, LLC. ANY REPRODUCTION IN PART OR AS A WHOLE WITHOUT THE WRITTEN PERMISSION OF HSIO TECHNOLOGIES, LLC IS PROHIBITED.

UNLESS OTHERWISE SPECIFIED:
 DIMENSIONS ARE IN MILLIMETERS
 TOLERANCES:
 ANGULAR: ±1°
 XX: ±0.25
 XXX: ±0.10
 XXXX: ±0.050

INTERPRET GEOMETRIC TOLERANCING PER:
 MATERIAL
 SEE BOM
 FINISH
 DO NOT SCALE DRAWING

NAME	DATE
AS	02/21/13
CHECKED	DATE
MP	02/21/13

LEGEND:
 △ NOTE CALLOUT
 ○ REVISION CHANGE
 ○ ITEM NUMBER

HSIO TECHNOLOGIES, LLC.
 13300 67th AVENUE NORTH
 MAPLE GROVE, MINNESOTA 55311
 763-447-6260

TITLE:
 SCKT, 134GRY11X11.5-0.65

DWG. NO. **106918-0012** REV **A**

SCALE: 10:1 SIZE: C SHEET 1 OF 2

SOCKET FOR DEVICES THAT ARE WITHIN THESE SPECIFICATIONS				
Lead Count	N	134	Package Size	D 11.00
Columns	ND	10		E 11.50
Rows	NE	17	Ball Spacing	D1 5.85
Pitch	e	0.65		E1 10.40
Ball Size	b	0.40±0.05	Encapsulant/Top Size	D2 n/a
Total Thickness	A	n/a	Pattern Style	IRREGULAR*
Ball Height	A1	0.25 Min	Perimeter Rows	n/a
Substrate Thickness	A2	n/a	Center Array	n/a
Top Thickness	A3	n/a		
Form Tolerances				
Edge	aaa	0.20	Bottom	ddd 0.15
Substrate	bbb	0.20	Position	eee 0.20
Top	ccc	0.20	Position	fff 0.08

All dimensions are in millimeters.
*See footprint specification for pattern details.

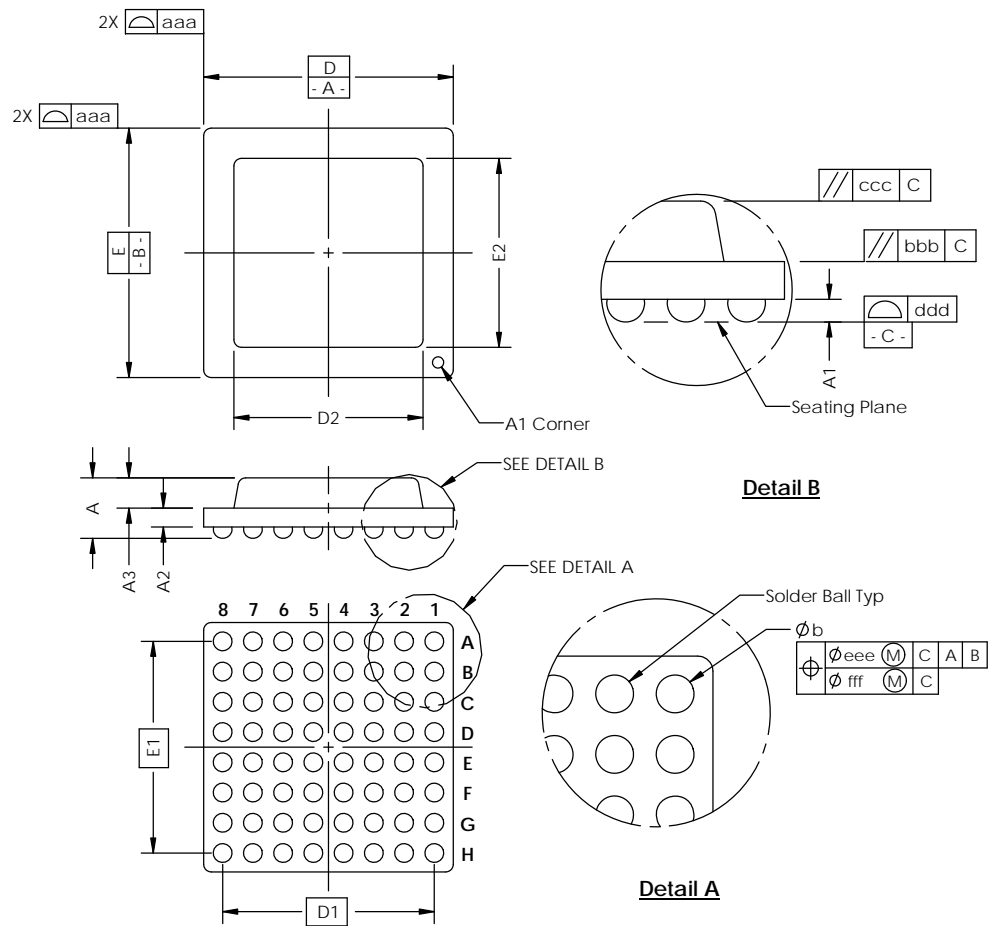
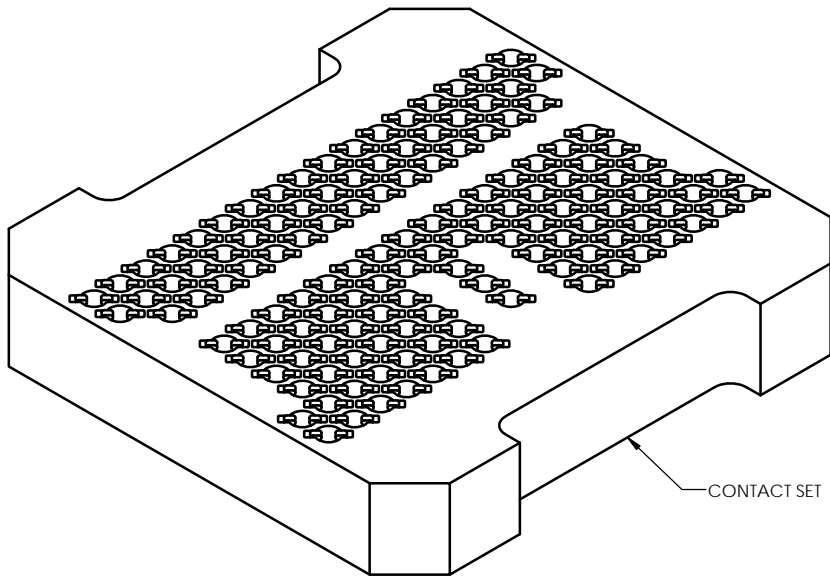

Generic Representation with Full Grid Array

PROPRIETARY AND CONFIDENTIAL			
THE INFORMATION CONTAINED IN THIS DRAWING IS THE SOLE PROPERTY OF HSIO TECHNOLOGIES, LLC. ANY REPRODUCTION IN PART OR AS A WHOLE WITHOUT THE WRITTEN PERMISSION OF HSIO TECHNOLOGIES, LLC IS PROHIBITED.			
UNLESS OTHERWISE SPECIFIED:	NAME	DATE	HSIO TECHNOLOGIES, LLC. 13300 67th AVENUE NORTH MAPLE GROVE, MINNESOTA 55311 763-447-6260
DIMENSIONS ARE IN MILLIMETERS	DRAWN	AS 02/21/13	
TOLERANCES: ANGULAR: ± 1° XX ±0.25 X.XX ±0.10 X.XXX ±0.050	CHECKED	MP 02/21/13	
LEGEND: △ NOTE CALLOUT ○ REVISION CHANGE ○ ITEM NUMBER			TITLE: SCKT, 134GRY11X11.5-0.65
		DWG. NO.	REV
		106918-0012	A
		SCALE: 10:1	SIZE: C SHEET 2 OF 2