

Notes:

1. Footprint part number 104311-0067.
2. Dimension locates center of contact.
3. Press size: 16.25 x 16.25.

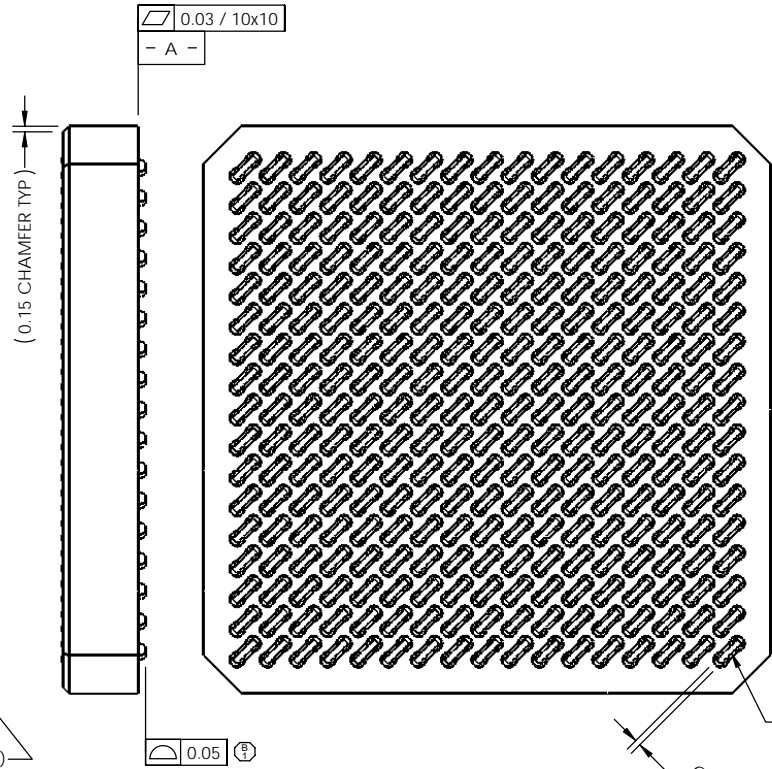
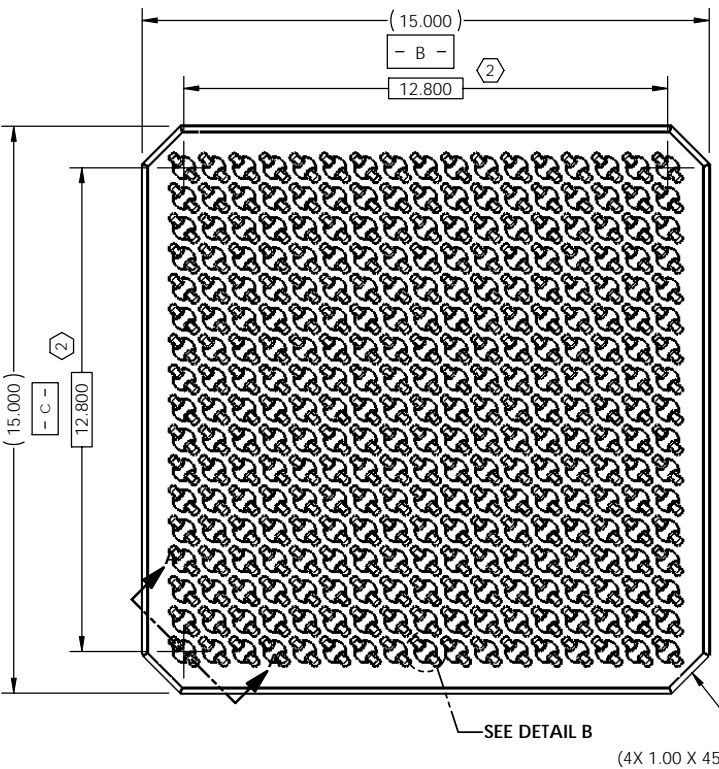

SEE DETAIL B
(4X 1.00 X 45°)

CONTACT
CONTACT THICKNESS WITH PLATING (0.163)
CONTACT $\phi 0.10$

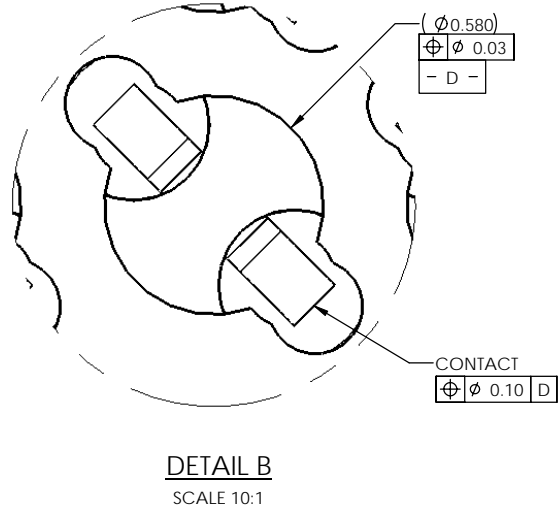
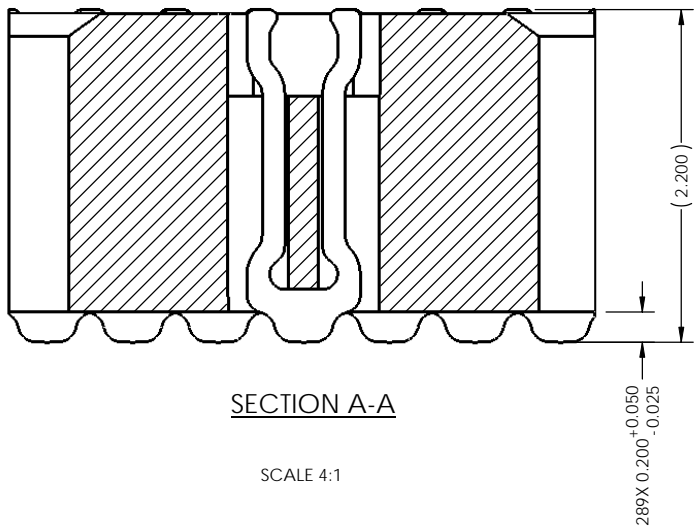

Parts List		
Item	Part Number	Description
1	104670-0019	CONN, 289GRY15-0.80
2	104671-0018	CS, 289GRY15-0.80
3	106394-0001	PRESS, DEVICE INSERT

B	AS	Modified dimensioning in Section A-A; Added detail B; 1) Added	MP	12/12/07	
A	SK	Initial Design	MP	12/07/07	
REV	ECO	BY	DESCRIPTION	APV	DATE

GRYPHICS

UNLESS OTHERWISE SPECIFIED DIMENSIONS ARE IN MILLIMETERS

TOLERANCES UNLESS OTHERWISE NOTED:

ANGLES	±1°
X.X	±0.25
X.XX	±0.10
X.XXX	±0.050

DO NOT SCALE DRAWING

THE INFORMATION CONTAINED IN THIS DRAWING IS THE SOLE PROPERTY OF GRYPHICS, INC. ANY REPRODUCTION IN PART OR WHOLE WITHOUT THE WRITTEN PERMISSION OF GRYPHICS, INC. IS PROHIBITED

DRAWN: S. Klanderud	CHECKED:	APP'VD: M. Peery
DATE: 12/07/07	DATE:	DATE: 12/07/07

TITLE

CONN, 289GRY15-0.80

DWG. NO.	MATERIAL	REV.
104670-0019		B
		PAGE 1 OF 2

289GRY15-0.80

Lead Count	N	289	Package Size	D	15.00
Columns	ND	17		E	15.00
Rows	NE	17	Ball Spacing	D1	12.80
Pitch	e	0.80		E1	12.80
Ball Size	b	0.50±0.05	Encapsulant/ Top Size	D2	n/a
Total Thickness	A	N/A		E2	n/a
Ball Height	A1	0.30 Min	Pattern Style	Full Array	
Substrate Thickness	A2	N/A	Perimeter Rows	n/a	
Top Thickness	A3		Center Array	n/a	
Form Tolerances					
Edge	aaa	0.20	Bottom	ddd	0.15
Substrate	bbb	0.20	Position	eee	0.20
top	ccc	0.20	Position	fff	0.08

All dimensions are in millimeters.

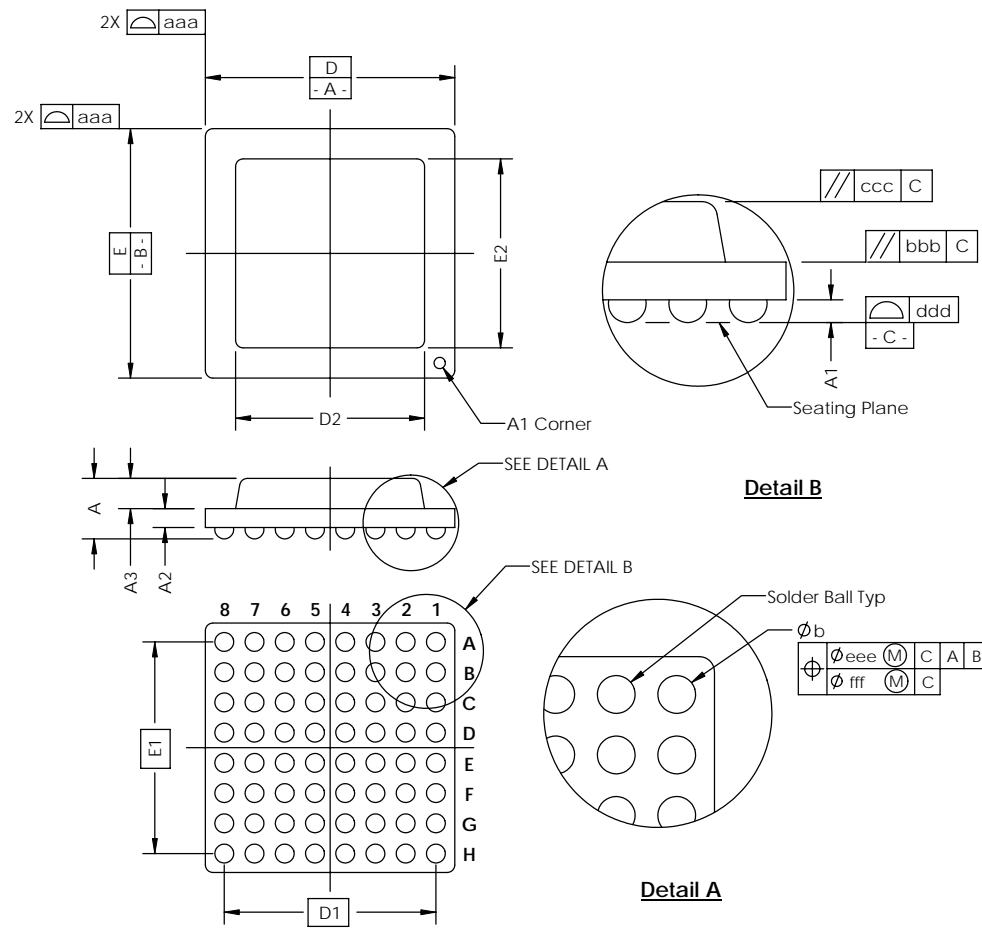
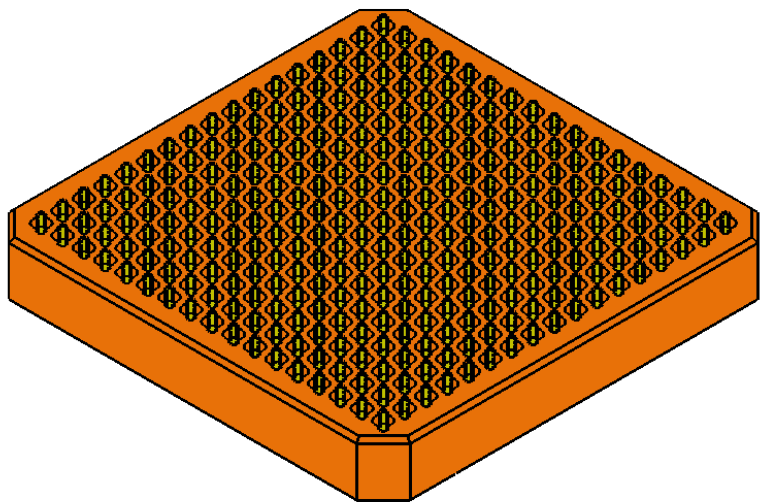

Generic Representation with Full Grid Array

<h1>GRYPHICS</h1>	UNLESS OTHERWISE SPECIFIED DIMENSIONS ARE IN MILLIMETERS	
	TOLERANCES UNLESS OTHERWISE NOTED:	
DO NOT SCALE DRAWING	ANGLES	±1°
	X.X	±0.25
	X.XX	±0.10
	X.XXX	±0.050
THE INFORMATION CONTAINED IN THIS DRAWING IS THE SOLE PROPERTY OF GRYPHICS, INC. ANY REPRODUCTION IN PART OR WHOLE WITHOUT THE WRITTEN PERMISSION OF GRYPHICS, INC. IS PROHIBITED		
TITLE CONN, 289GRY15-0.80		
DWG. NO. 104670-0019	MATERIAL See Page 1	REV. B PAGE 2 OF 2