

REV	ECO	BY	DESCRIPTION	APV	DATE
A	30863	SK	Initial Design	KW	08/12/11

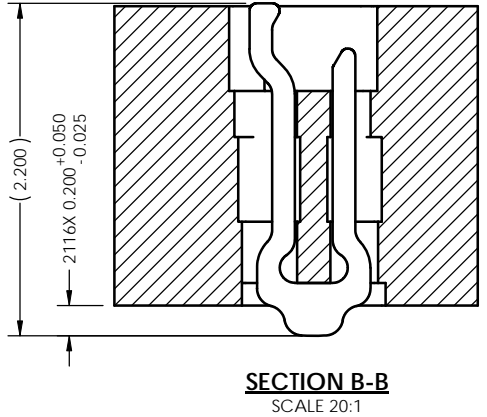
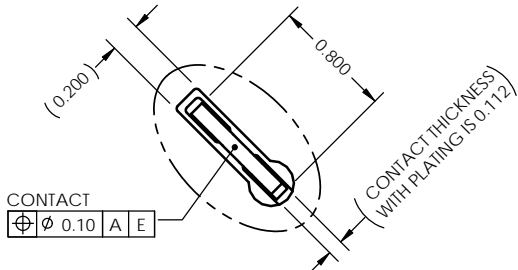
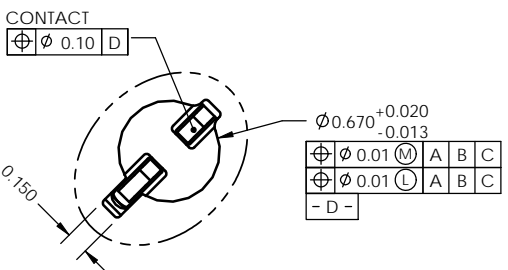
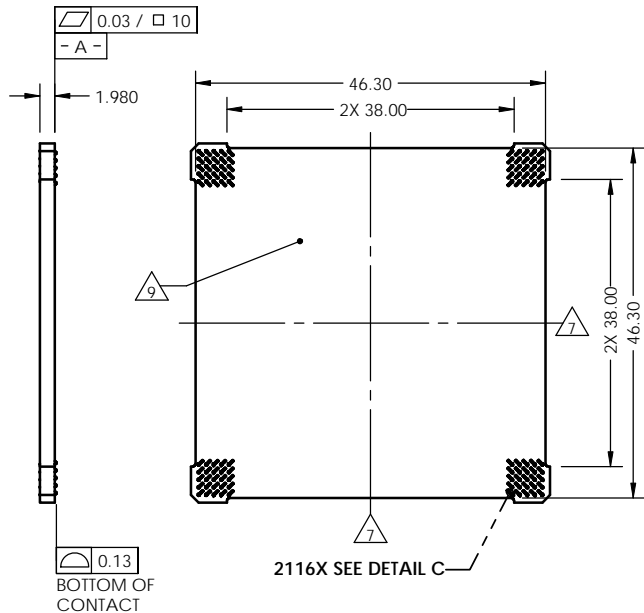
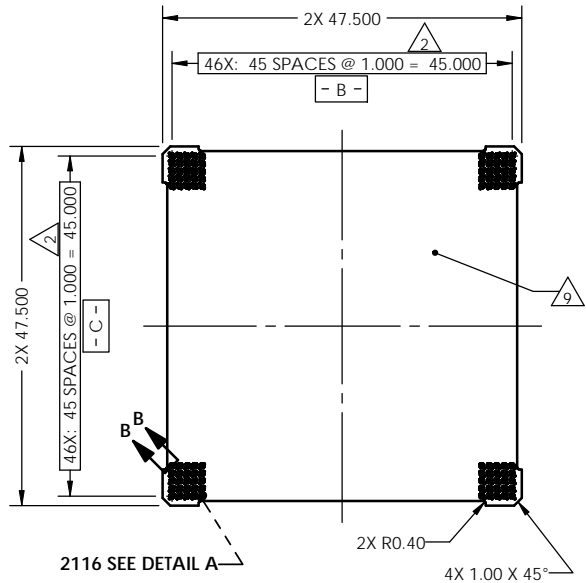

- Notes:
- Footprint part number is 104311-0288.
  - Dimension locates center of slot/contact.
  - Unless otherwise noted, all features located  $\text{Ø} 0.10 \text{ A B C}$
  - Reference Cascade Microtech specification 103862-0001.
  - Press size is 47.5 x 47.5.
  - Datum  $- B -$  and  $- C -$  are determined by  $\text{Ø} 0.670$  opening in corner slots.
  - $- E -$  center of contact pattern.
  - Reference Cascade Microtech specification 103863-0001 for application notes.
  - Not all slots and contacts are shown.

PARTS LIST		
PART NUMBER	QTY	DESCRIPTION
106652-0020	-	SCKT, 2116G8047.5-1.00
106651-0020	1	CS, 2116G8047.5-1.00
103864-0134	1	PRESS, DEV, 47.5 (SOLD SEPARATELY)
104553-0218	1	STENCIL, 2116G8047.5-1.00 (SOLD SEPARATELY)

UNLESS OTHERWISE SPECIFIED  
DIMENSIONS ARE IN MILLIMETERS  
DIM5 APPLY AFTER PLATING  
TOLERANCES UNLESS OTHERWISE NOTED:

ANGLES ±1°	DECIMALS XX ±0.25 XXX ±0.10 XXXX ±0.050
------------	--

LEGEND:  
 (A) NOTE CALLOUT  
 (B) REVISION CHANGE  
 (C) ITEM NUMBER

THE INFORMATION CONTAINED IN THIS DRAWING IS THE SOLE PROPERTY OF CASCADE MICROTECH, INC. ANY REPRODUCTION IN PART OR WHOLE WITHOUT THE WRITTEN PERMISSION OF CASCADE MICROTECH, INC. IS PROHIBITED.

CAD GENERATED DRAWING  
DO NOT MANUALLY UPDATE

DRAWING APPROVALS

DESIGN: S. Klanderud	DATE 08/12/11
APPROV: K. Wilson	DATE 08/12/11

THIRD ANGLE PROJECTION

SCALE C	CAD FORMAT SOLIDWORKS	DESCRIPTION 106652-0020	REV A
SEE BOM		SHEET 1 of 2	

7115 NORTHLAND TERRACE SUITE 400  
BROOKLYN PARK, MN 55428  
(763) 509-0066

**SCKT, 2116G8047.5-1.00**

**DETAIL A (2116X)**  
SCALE 20:1

**DETAIL C (2116X)**  
SCALE 20:1

**SECTION B-B**  
SCALE 20:1

SOCKET FOR DEVICES THAT ARE WITHIN THESE SPECIFICATIONS					
Lead Count	<b>N</b>	2116	Package Size	<b>D</b>	47.50
Columns	<b>ND</b>	46		<b>E</b>	47.50
Rows	<b>NE</b>	46	Ball Spacing	<b>D1</b>	45.000
Pitch	<b>e</b>	1.00		<b>E1</b>	45.000
Ball Size	<b>b</b>	0.60±0.05	Encapsulant/ Top Size	<b>D2</b>	N/A
Total Thickness	<b>A</b>	N/A		<b>E2</b>	N/A
Ball Height	<b>A1</b>	0.375 MIN	Pattern Style	FULL GRID	
Substrate Thickness	<b>A2</b>	N/A	Perimeter Rows	N/A	
Top Thickness	<b>A3</b>		Center Array	N/A	
Form Tolerances					
Edge	<b>aaa</b>	0.20	Bottom	<b>ddd</b>	0.15
Substrate	<b>bbb</b>	0.20	Position	<b>eee</b>	0.20
top	<b>ccc</b>	0.20	Position	<b>fff</b>	0.08

All dimensions are in millimeters.  
\* See footprint for pattern details.

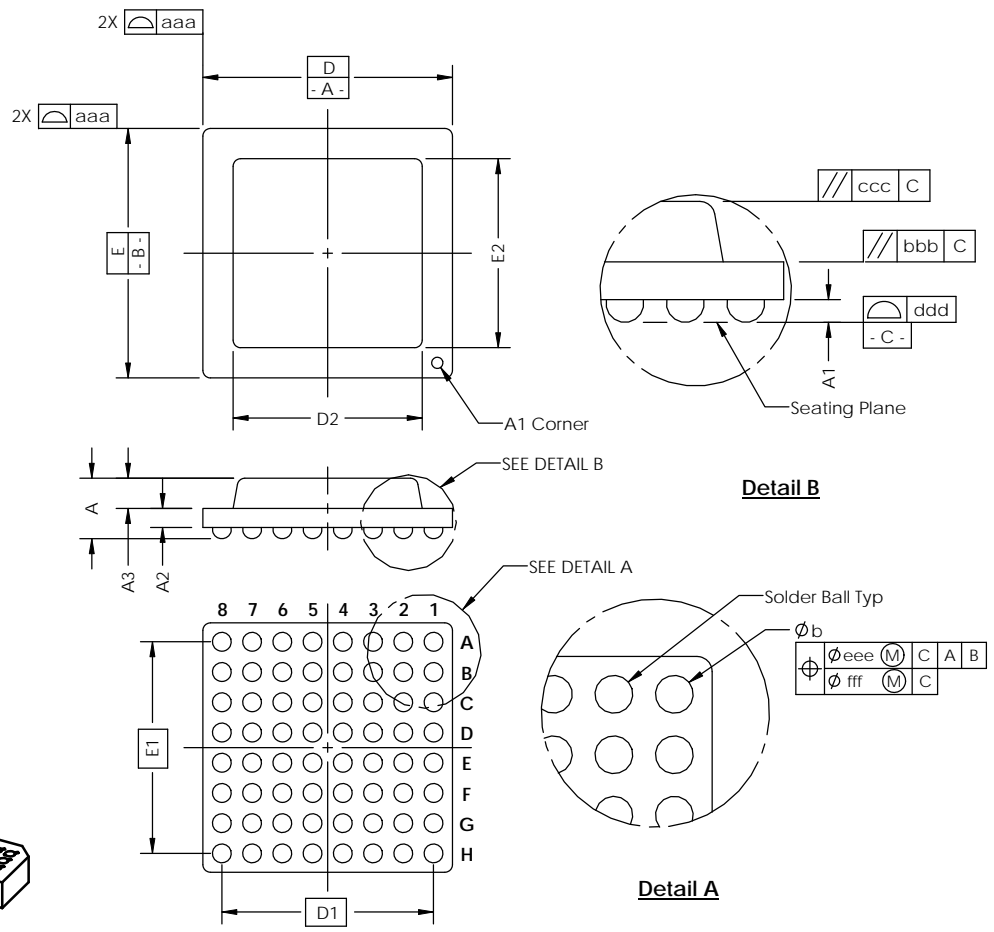
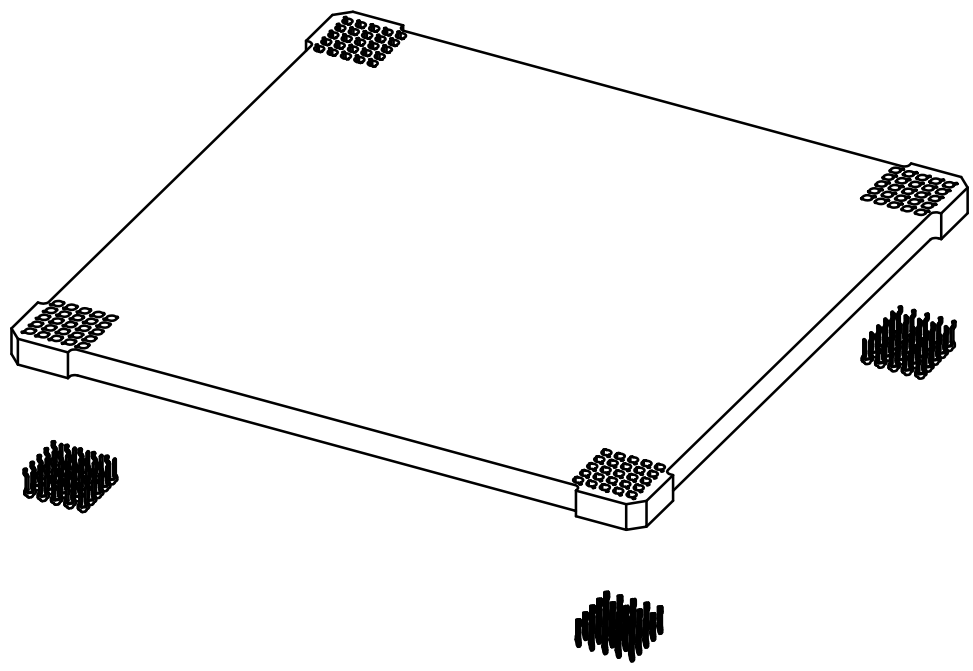

**Generic Representation with Full Grid Array**

THE INFORMATION CONTAINED IN THIS DRAWING IS THE SOLE PROPERTY OF CASCADE MICROTECH, INC.  
ANY REPRODUCTION IN PART OR WHOLE WITHOUT THE WRITTEN PERMISSION OF CASCADE MICROTECH, INC. IS PROHIBITED.

UNLESS OTHERWISE SPECIFIED  
- DIMENSIONS ARE IN MILLIMETERS  
- DIMES APPLY AFTER PLATING  
TOLERANCES UNLESS OTHERWISE NOTED:

ANGLES	DECIMALS
±1°	X.X .0125
	X.XX .0130
	X.XXX ±.050

LEGEND:

- (X) NOTE CALLOUT
- (R) REVISION CHANGE
- (I) ITEM NUMBER

7115 NORTHLAND TERRACE SUITE 400 BROOKLYN PARK, MN 55428 (763) 509-0066	
<b>SCKT, 2116G8047.5-1.00</b>	
SCALE: C	DATE: 10/20/10
DRAWN BY: SOLIDWORKS	DRAWING NO: 106652-0020
MATERIAL: See Page 1	REV: A
PAGE: 2 of 2	