

REV	ECO	BY	DESCRIPTION	APV	DATE
A	31690	RS	Initial Design	NSJ	09/16/15

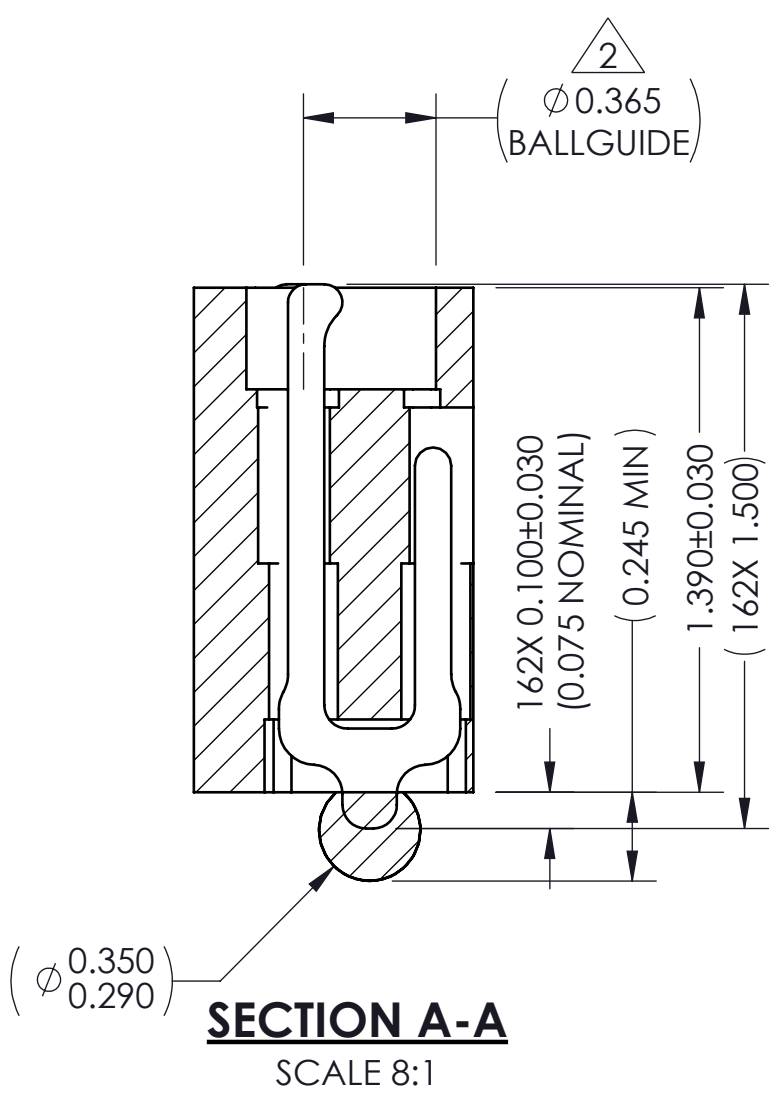
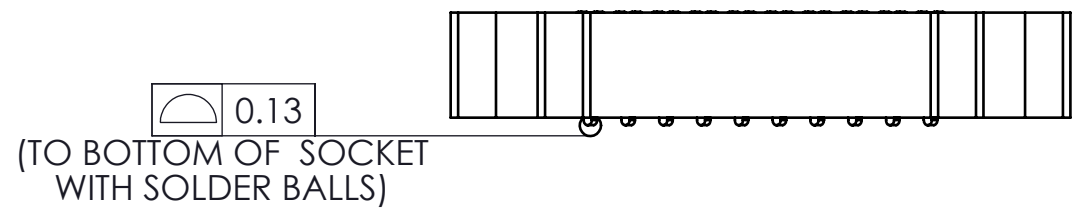
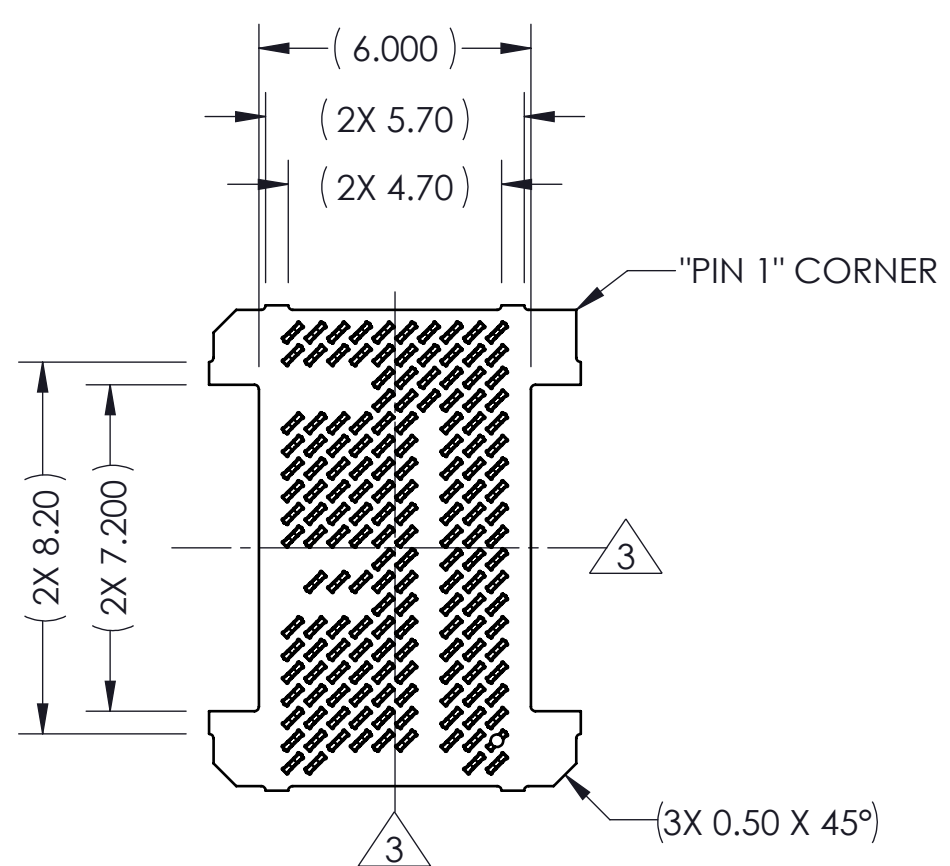
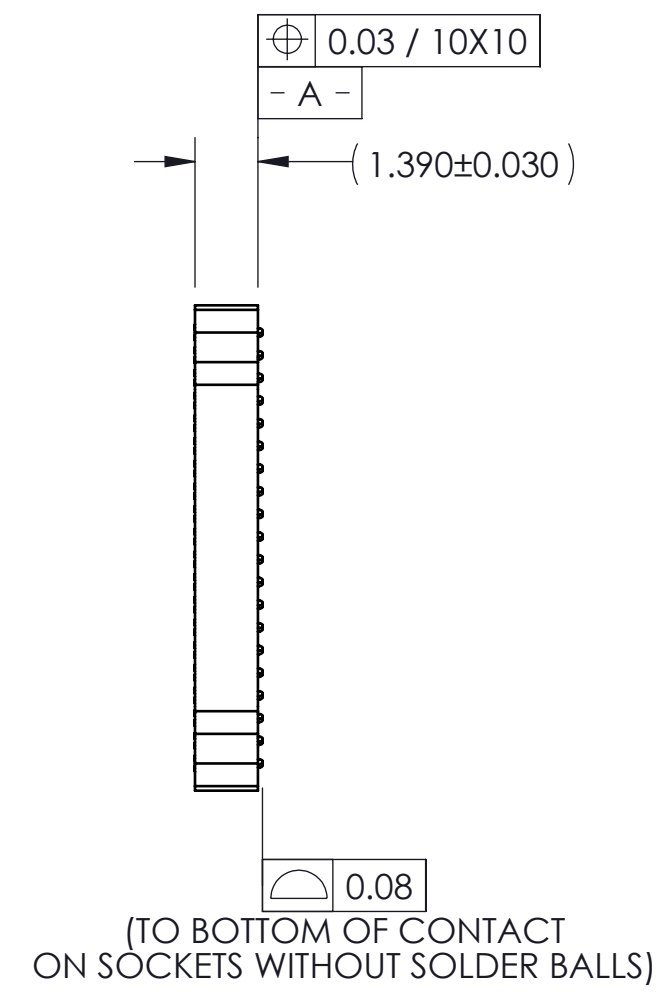
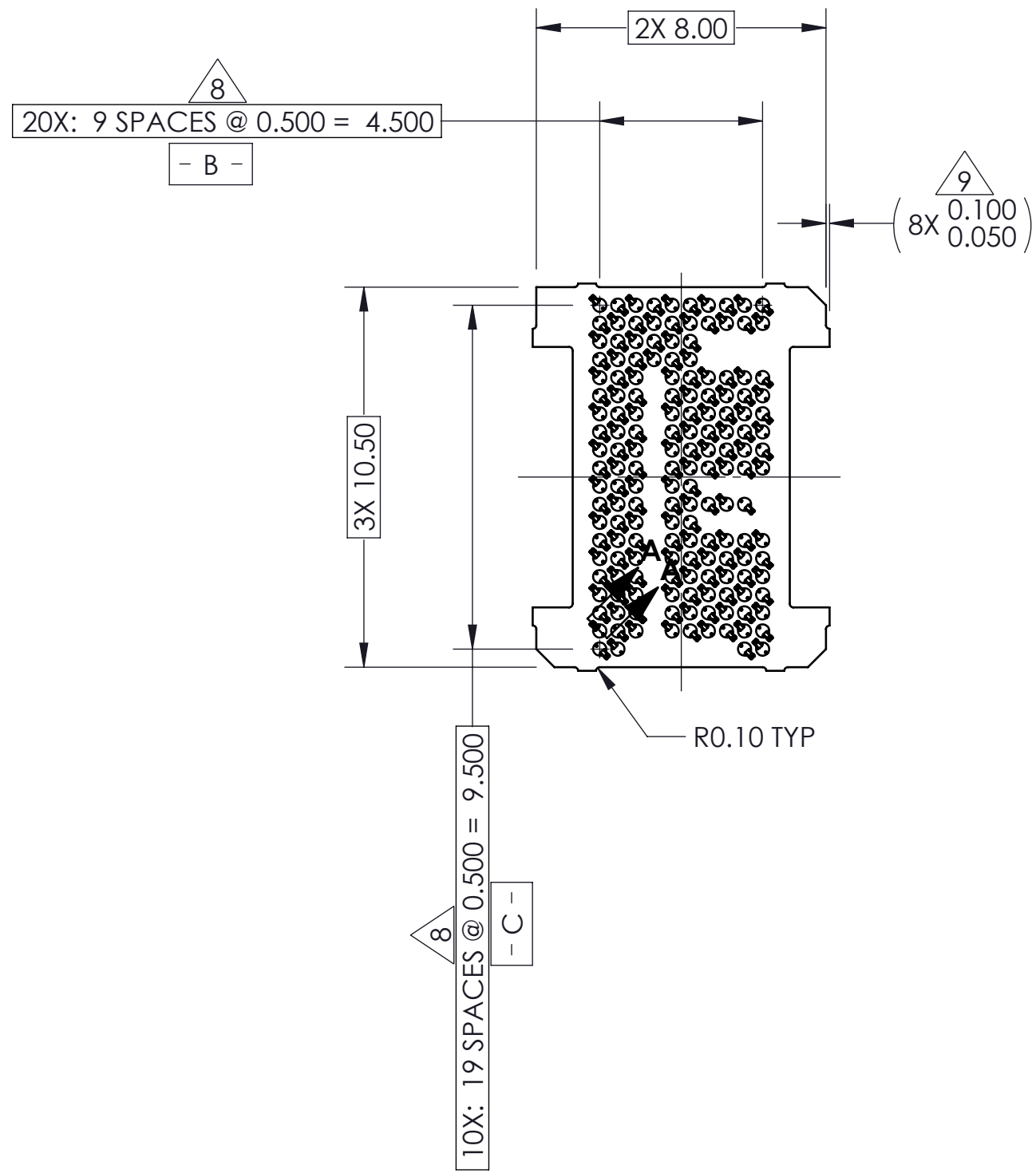

Notes:

- 1 Unless otherwise noted, all features located  $\oplus 0.10$  A B C
- 2 Datum's - B - and - C - are determined by  $\phi 0.365$  features on corner slots.
- 3 Center of contact pattern.
- 5 Reference HSIO Technologies specification 700001-0001 for solder attachment.
- 6 Reference HSIO Technologies specification 700001-0002 for application notes.
- 7 All contacts/solder balls are not shown to minimize file size.
- 8 Dimension locates center of contact/slot.
- 9 Tooling marks permitted. Maximum 0.100 protrusion shown.

PART NUMBER	DESCRIPTION
109054-0001	SCKT, 162G40 8.0X10.5-0.50 (EUTECTIC SOLDER BALL)
109054-0002	SCKT, 162G40 8.0X10.5-0.50 (SAC305 SOLDER BALL)
109054-0003	SCKT, 162G40 8.0X10.5-0.50 (WITHOUT SOLDER BALL)
103864-0031	PRESS DEVICE INSERT, 8.0X10.0 (SOLD SEPARATELY)
104553-0404	STENCIL, FLEX, 162G40 8.0X10.5-0.50 (SOLD SEPARATELY)
108639-0065	ALIGNMENT FRAME, 8.0 X 10.5 (SOLD SEPARATELY)
105900-0004	EXTRACTION TOOL, 4 X 53 (SOLD SEPARATELY)

<p><b>HSIO technologies</b> PROPRIETARY AND CONFIDENTIAL</p> <p>THE INFORMATION CONTAINED IN THIS DRAWING IS THE SOLE PROPERTY OF HSIO TECHNOLOGIES, LLC. ANY REPRODUCTION IN PART OR AS A WHOLE WITHOUT THE WRITTEN PERMISSION OF HSIO TECHNOLOGIES, LLC IS PROHIBITED.</p>	UNLESS OTHERWISE SPECIFIED:	NAME	DATE	<b>HSIO TECHNOLOGIES, LLC.</b> 13300 67th AVENUE NORTH MAPLE GROVE, MINNESOTA 55311 763-447-6260	
	DIMENSIONS ARE IN MILLIMETERS	DRAWN	RS		09/16/15
	TOLERANCES:	CHECKED	NSJ	09/16/15	TITLE: SCKT, 162G40 8.0X10.5-0.50
	ANGULAR: $\pm 1^\circ$ X.X $\pm 0.25$ X.XX $\pm 0.10$ X.XXX $\pm 0.050$	LEGEND:			
INTERPRET GEOMETRIC TOLERANCING PER:	$\triangle$ NOTE CALLOUT $\square$ REVISION CHANGE $\circ$ ITEM NUMBER		DWG. NO. <b>109054-XXXX</b>		
MATERIAL	SEE BOM		REV	<b>A</b>	
FINISH	DO NOT SCALE DRAWING		SCALE: 10:1	SIZE: C	
				SHEET 1 OF 2	

**SOCKET FOR DEVICES THAT ARE WITHIN THESE SPECIFICATIONS**

Lead Count	<b>N</b>	162	Package Size	<b>D</b>	11.50
Columns	<b>ND</b>	10		<b>E</b>	13.00
Rows	<b>NE</b>	20	Ball Spacing	<b>D1</b>	4.500
Pitch	<b>e</b>	0.500		<b>E1</b>	9.500
Ball Size	<b>b</b>	0.30±0.05	Encapsulant/ Top Size	<b>D2</b>	N/A
Total Thickness	<b>A</b>	N/A		<b>E2</b>	N/A
Ball Height	<b>A1</b>	0.200 MIN	Pattern Style	IRREGULAR	
Substrate Thickness	<b>A2</b>	N/A	Perimeter Rows	N/A	
Top Thickness	<b>A3</b>		Center Array	N/A	

**Form Tolerances**

Edge	<b>aaa</b>	0.20	Bottom	<b>ddd</b>	0.15
Substrate	<b>bbb</b>	0.20	Position	<b>eee</b>	0.20
Top	<b>ccc</b>	0.20	Position	<b>fff</b>	0.10

\* All dimensions are in millimeters.

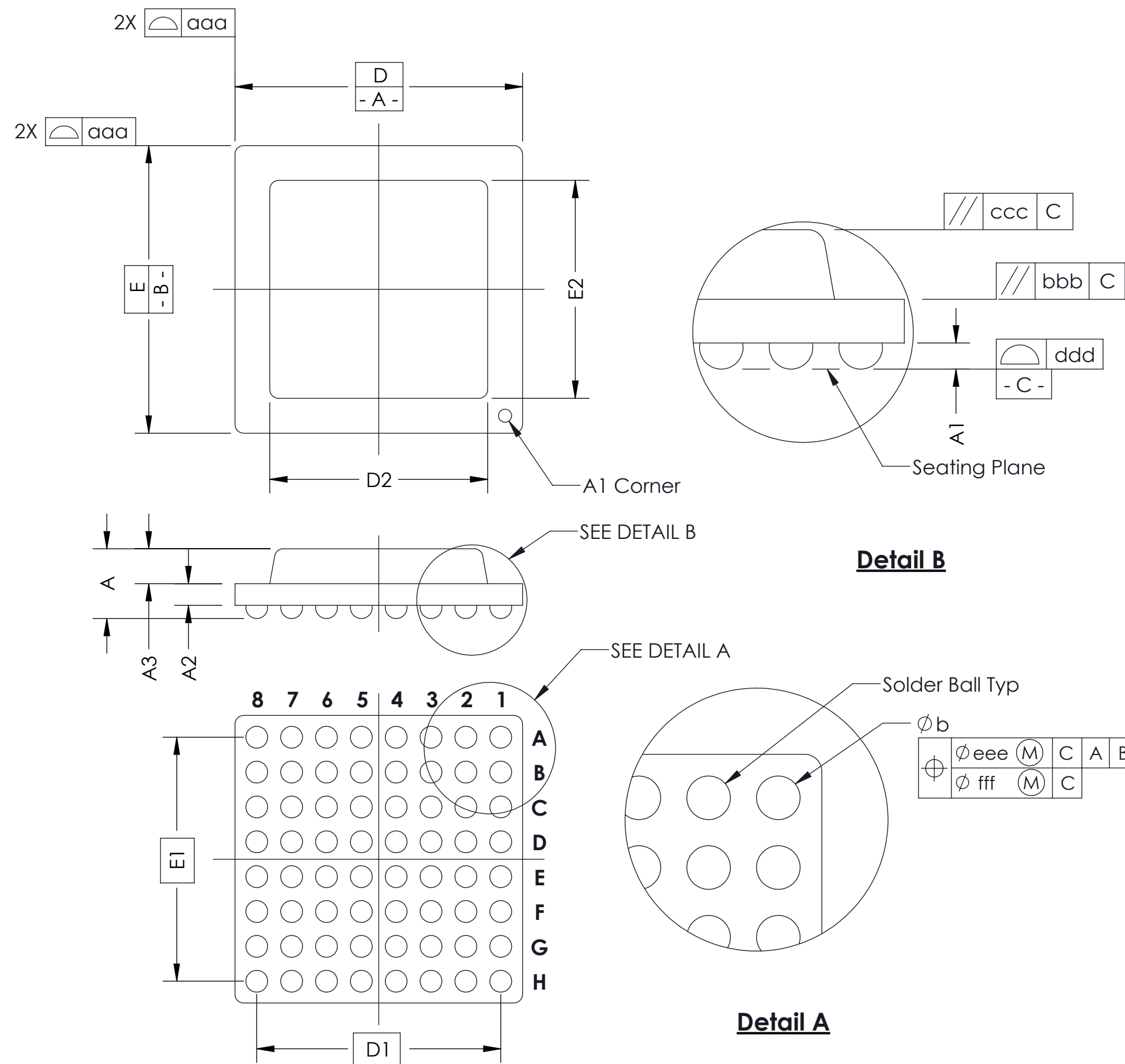
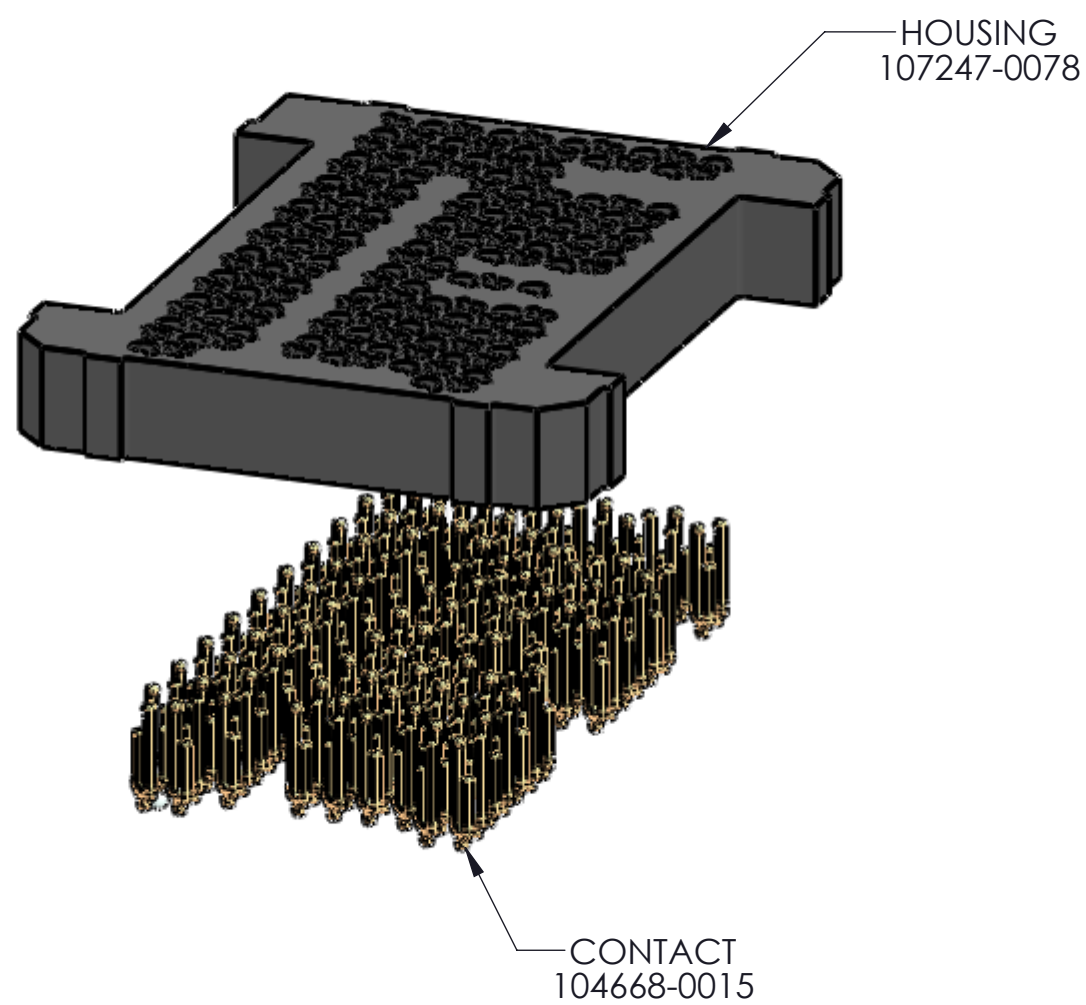

**Generic Representation with Full Grid Array**

<p><b>HSIO technologies</b> PROPRIETARY AND CONFIDENTIAL</p> <p>THE INFORMATION CONTAINED IN THIS DRAWING IS THE SOLE PROPERTY OF HSIO TECHNOLOGIES, LLC. ANY REPRODUCTION IN PART OR AS A WHOLE WITHOUT THE WRITTEN PERMISSION OF HSIO TECHNOLOGIES, LLC IS PROHIBITED.</p>	UNLESS OTHERWISE SPECIFIED: DIMENSIONS ARE IN MILLIMETERS TOLERANCES: ANGULAR: ± 1° X.X ±0.25 X.XX ±0.10 X.XXX ±0.050	DRAWN RS 09/16/15	NAME RS	DATE 09/16/15	<p><b>HSIO TECHNOLOGIES, LLC.</b> 13300 67th AVENUE NORTH MAPLE GROVE, MINNESOTA 55311 763-447-6260</p>
	INTERPRET GEOMETRIC TOLERANCING PER:	CHECKED NSJ 09/16/15	LEGEND: △ NOTE CALLOUT □ REVISION CHANGE ○ ITEM NUMBER		
	MATERIAL SEE BOM	DO NOT SCALE DRAWING	DWG. NO. <b>109054-XXXX</b>		REV <b>A</b>
	FINISH		SCALE: 10:1	SIZE: C	SHEET 2 OF 2